

Room 1

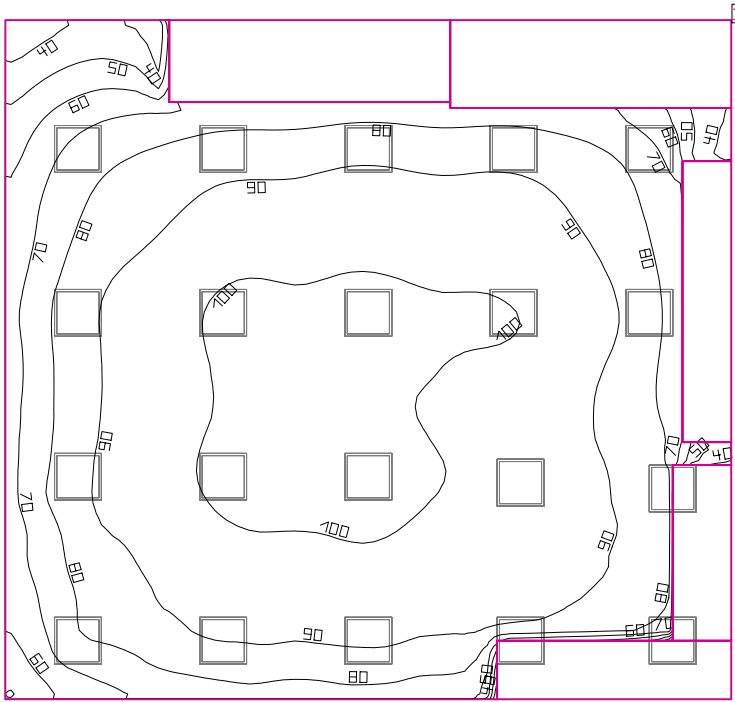

Clearance height: 10.000 ft, Reflection factors: Ceiling 68.8%, Walls 41.7%, Floor 20.0%, Light loss factor: 0.90

Workplane

Surface	Result	Average (Target)	Min	Max	Mean/Min	Max/Min
1 Workplane 1	Perpendicular illuminance (adaptive) [fc] Height: 2.500 ft, Wall zone: 0.000 ft	87.53 (≥ 92.90)	31.42	104	2.79	3.31

#	Luminaire	Φ(Luminaire) [lm]	Power [W]	Luminous efficacy [lm/W]
20	Lithonia Lighting - EPANL 22 34LHE 40K xxx EPANL 22 34LHE 40K xxx	5001	40.0	125.0
Total via all luminaires		100020	800.0	125.0

Lighting power density: 0.89 W/sq ft = 0.09 W/sq ft/10 fc (Floor area of room 899.02 sq ft)

The energy consumption quantities refer to the lights planned for the room without taking into account light scenes and their dimming levels.
Consumption: 1800 kWh/a of maximum 2950 kWh/a

Room 1



Lithonia Lighting EPANL 22 34LHE 40K xxx EPANL 22 34LHE 40K xxx

No.	X [ft]	Y [ft]	Mounting height [ft]
1	3.100	2.500	10.000
2	9.300	2.500	10.000
3	15.500	2.500	10.000
4	22.000	2.500	10.000
5	28.500	2.500	10.000
6	3.100	9.500	10.000
7	9.300	9.500	10.000
8	15.500	9.500	10.000
9	22.000	9.250	10.000
10	28.500	9.000	10.000
11	3.100	16.500	10.000
12	9.300	16.500	10.000
13	15.500	16.500	10.000
14	21.700	16.500	10.000
15	27.500	16.500	10.000
16	3.100	23.500	10.000
17	9.300	23.500	10.000
18	15.500	23.500	10.000
19	21.700	23.500	10.000
20	27.500	23.500	10.000